

2-in-1

Upright & Handheld Vacuum

Instruction Manual

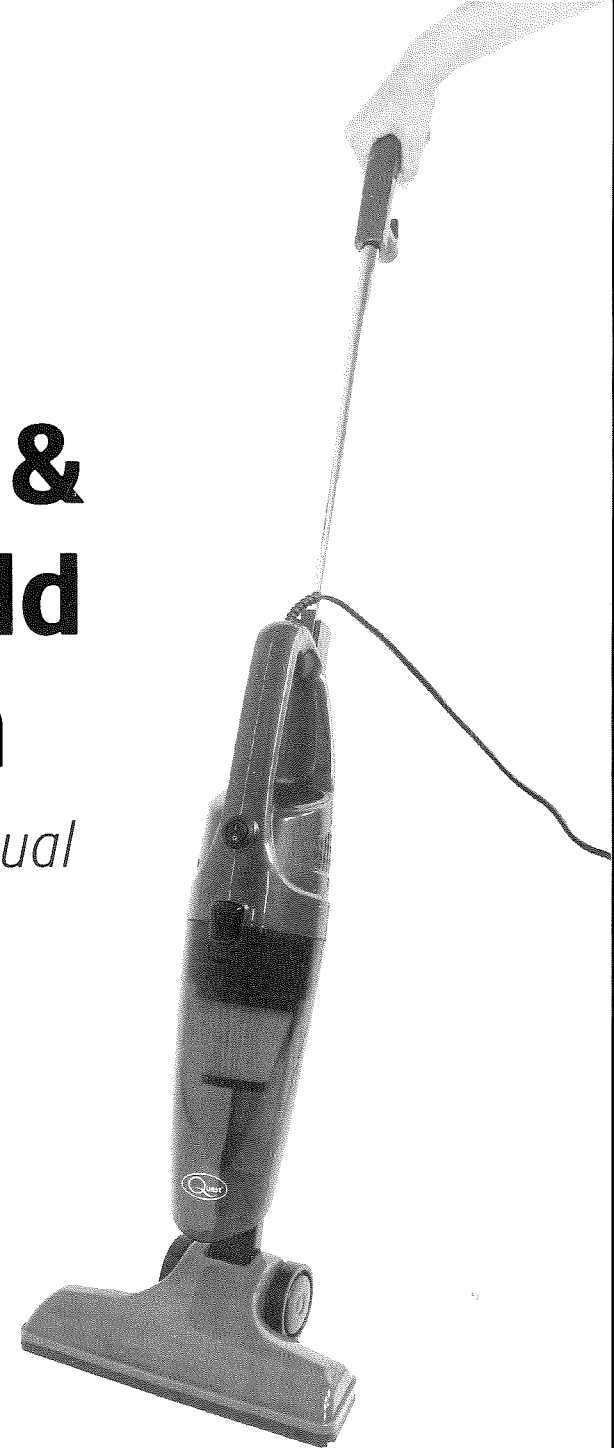

Item No. 44829 & 44839

IMPORTANT! SAFETY INSTRUCTIONS:



READ THIS MANUAL BEFORE USING THIS APPLIANCE.



WARNING! READ ALL SAFETY WARNINGS AND INSTRUCTIONS FAILURE TO FOLLOW THE WARNINGS AND INSTRUCTIONS LISTED BELOW MAY RESULT IN ELECTRIC SHOCK, FIRE AND/OR INJURY

- **The intended use of this appliance is explained in this manual. The use of accessories other than those recommended in this manual may present a risk of personal injury.**
- **Always check the mains voltage corresponds to the voltage on the rating plate.**

WARNING:

1. This appliance uses a washable filter system with convenient operation and effective cleaning.
2. This appliance uses a cyclone filter system with bagless design.
3. This machine is suitable for domestic use only.
4. This appliance with mould design can be repaired easily.
5. This appliance comes with a dust cup design which is easy to detach and wash.
6. Maximum noise level is approximately around 70db.

TO AVOID ELECTRIC SHOCKS

- Do not use the appliance outdoors.
- Never use the vacuum cleaner if the cable plug or casing are damaged.
- To avoid risks, arrange for damaged power cables and/or plugs to be replaced as soon as possible by a qualified specialist.
- Arrange for repairs to be carried out only by specialist workshops. Under no circumstances should you open the appliance yourself. Repairs that are not carried out by a specialist workshop could lead to physical injuries and void any warranty which may come with this appliance.

- Before switching the hand vacuum cleaner on ensure that the mains voltage corresponds to the voltage indicated in the technical data label for the appliance.
- Never touch the power supply or the appliance with wet or damp hands
- Always unplug the appliance when not in use!!
- Do not use extension cables or leads with this appliance!
- Do not change any accessories while the appliance is switched on.
- Do not use the vacuum cleaner for vacuuming up sharp objects or glass shards
- Do not insert foreign objects into the air flow vents
- Never vacuum up burning matches, glowing ashes or cigarette butts.
- Do not use the vacuum cleaner for vacuuming up chemical products, stone dust, gypsum, cement or similar particles.
- Do not use the vacuum cleaner for vacuuming up any type of liquid, water or similar particles.
- This appliance is not suitable for use with inflammable and explosive substances or chemical and aggressive liquids.
- Always store the appliance indoors. To prevent accidents, keep the appliance in a dry location when not in use and out of reach for small children.
- This appliance can be used by children aged from 8 years and above and persons with reduced physical, sensory or mental capabilities or lack of experience and knowledge if they have been given supervision or instruction concerning use of the appliance in a safe way and understand the hazards involved.
- Children shall not play with the appliance. This appliance is NOT a toy.
- Cleaning and user maintenance shall not be made by children without supervision.
- This appliance is not for commercial use! It is for household use only.
- Use only parts recommended and supplied by the manufacturer.

- Always grip the power plug to disconnect the appliance from the power supply.
- Always be sure to keep the vacuum away from heating elements, ovens or other heated appliances and surfaces.
- Always make certain that the ventilation slits are open. A blocked ventilation circuit can result in overheating and damage to the appliance.
- Take special care when using the vacuum on stairs.
- Do not use the vacuum without the dust filter inserted.
- Take extra care not to trip over the power cord and beware of your surroundings to ensure others do not trip over the power cord.

PRODUCT FUNCTION

FEATURES:

- Removable Handle & 2-in-1 design (A stick vac and a handheld vac).
- Lightweight stick design allows for easy use.
- Versatility and ability to vacuum awkward spaces.
- Works great on hard floors and is fast and easy to set up and easy to clean.
- It has a full set of parts to cover various cleaning requirements.

PRODUCT PARTS

- 1. Handle**
- 2. Power switch**
- 3. The dust hopper button**
- 4. The dust hopper**
- 5. Brush**
- 6. Dust channel**
- 7. Nozzle**

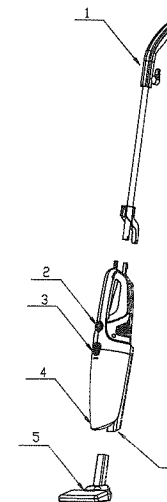

ASSEMBLY

- Insert the filter attachment into the dust container.
- Attach the dust container onto the main vacuum body and secure.
- Insert the stick handle onto the main vacuum body by sliding the handle down into place and locking. (NOTE: Please ensure that you align the handle attachment when fitting to the main body slot, as the handle attaches at a slight angle).
- Insert the floor brush or required attachment.

EMPTY DUST CONTAINER:

Simply remove the dust container from the main body and then remove the filter attachment inside the dust container and dispose of the dust into a bin. Then follow the above instruction to re-assemble the vacuum.

CAUTION: THE SUCTION INLET MUST BE OPEN AND FREE OF ANY OBSTRUCTIONS AT ALL TIMES. OTHERWISE, THE MOTOR WILL OVER-HEAT AND COULD BE DAMAGED.

PLEASE NOTE THE DUST FILTER IS WASHABLE.

It should, however, be replaced every three(3) to six(6) months depending on usage, to ensure best performance of your vacuum cleaner.

IMPORTANT MAKE SURE THAT DUST FILTER HAS COMPLETELY AIR DRIED BEFORE YOU REPLACE BACK INTO THE VACUUM CLEANER.

Never operate the vacuum without the dust filter in place.

INSTALLATION GUIDE

PLEASE DO NOT INSERT THE PLUG INTO THE POWER SOURCE DURING INSTALLATION

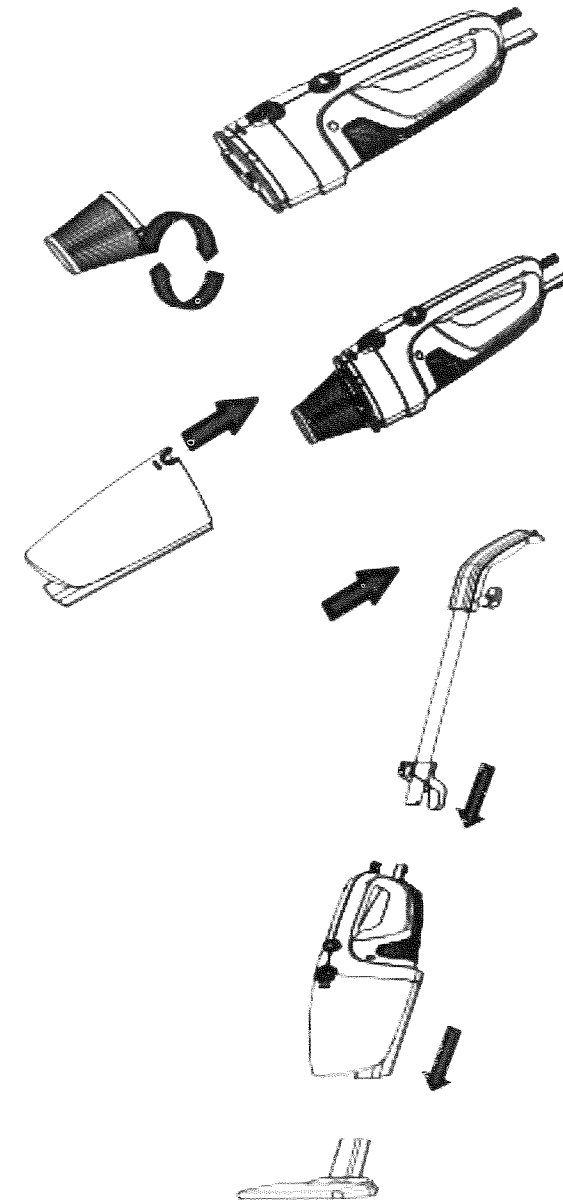

STEP 1

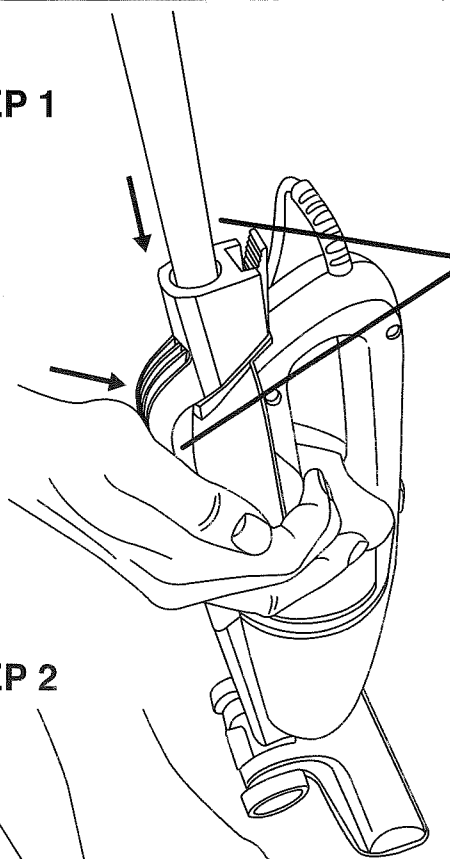

Put the handle inside of the hole, press the bottom of the small handle and push to the remaining part of channel.

STEP 2

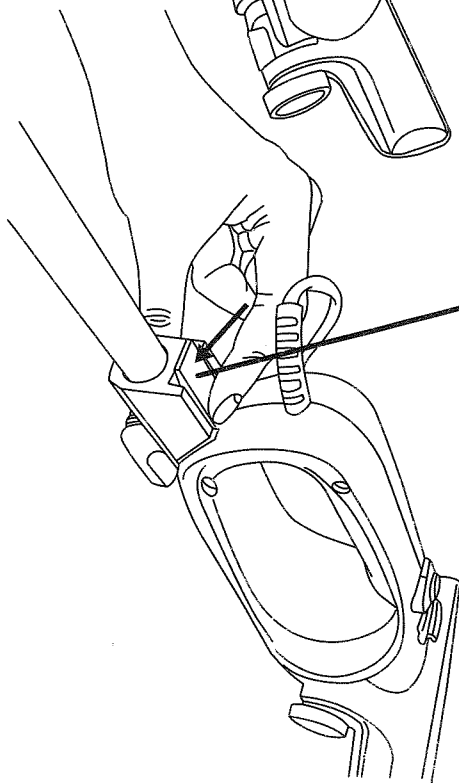

Press at the bottom side of button (place with 4 lines) and fully locked with dust container.

TROUBLESHOOTING

WHEN USING THIS PRODUCT SUCH AS ABNORMAL, PLEASE REVIEW THE FOLLOWING TABLE TO RESOLVE ITSELF.

PROBLEM	POSSIBLE REASON	POSSIBLE SOLUTION
Handheld vacuum cleaner does not work	No power socket	Check fuse or breaker, replace fuse/ reset breaker.
Handheld vacuum cleaner can not pick up dust; suction power has become weak.	<ol style="list-style-type: none"> 1. Dust container is full 2. Dust filter needs cleaning or replacement 	<ol style="list-style-type: none"> 1. Empty dust container 2. Remove dust filter assembly and check for object(s) in suction inlet and remove. Clean or replace dust filter assembly
Dust leak from handheld vacuum cleaner	<ol style="list-style-type: none"> 1. Dust container is full 2. Dust filter is not installed correctly. 3. Puncture/hole in dust filter 	<ol style="list-style-type: none"> 1. Empty dust container 2. Review the dust filter assembly installation instructions. 3. Replace dust filter assembly.
Strange noise when the appliance operates	<ol style="list-style-type: none"> 1. Check whether the floor brush and dust filter is blocked. 2. Check whether the dust container is full. 	Stop using the appliance. Clean the dust filter assembly and floor brush, empty the dust container. if the problem can not be resolved please contact a suitably qualified engineer for repair and servicing.

PLUG:

1. This appliance has been fitted with a BS UK compliant plug which should not be replaced or removed.
2. The plug is fitted with a UK compliant fuse link which is suitable for this type of appliance and should only be replaced by a fuse link of the same rating.
3. If access to the fuse link is only possible by removing the plug cover this must only be done by a suitably qualified person.
4. If the plug or the mains cable of this appliance is damaged do not use and dispose of the appliance responsibly.
5. This appliance is a Class 2 appliance protected by double and reinforced insulation and does not require earthing. Class 2 appliances are indicated by this  symbol marked on the appliance rating plate.

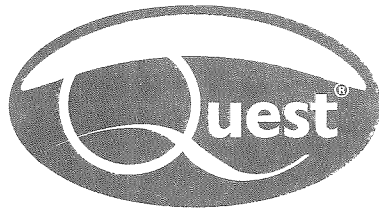

Information on Waste Disposal for Consumers of Electrical & Electronic Equipment

 This symbol indicates that this product should not be treated as normal household waste and it should be recycled. Please take it to your nearest collection facility or for further details contact your local council or visit www.recycle-more.co.uk.

Imported by Benross®



MADE IN P.R.C